

Brushless Resolver - type: 06-RX-2V19

TECHNICAL FEATURES:

Supply voltage	2.0±0.2	V
Frequency	19.2	kHz
Input current	max. 4	mA
Transformation ratio	1.0±0.1	
Error (-60°<9<60°)	max. ±20	min. arc
Error (0°<9<360°)	max. ±45	min. arc
Stator DC resistance	28.0±2.2	Ω
Rotor DC resistance	19.0±1.5	Ω
Insulating resistance	min. 100	M Ω
Phase shift	±2	degree
Fundamental null voltage	max. 10	mV
Total null voltage	max. 15	mV
Weight	max. 10	g

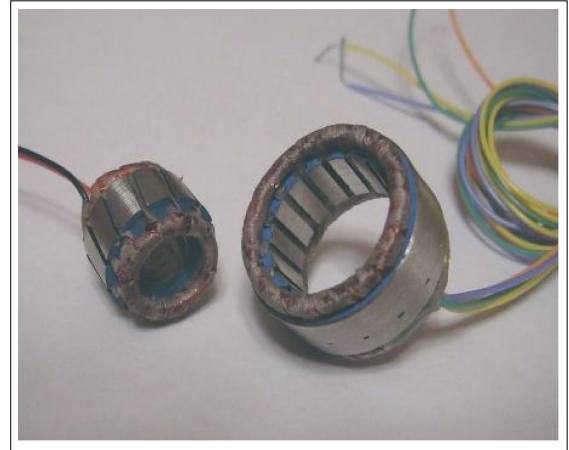

OVERALL DIMENSIONS:

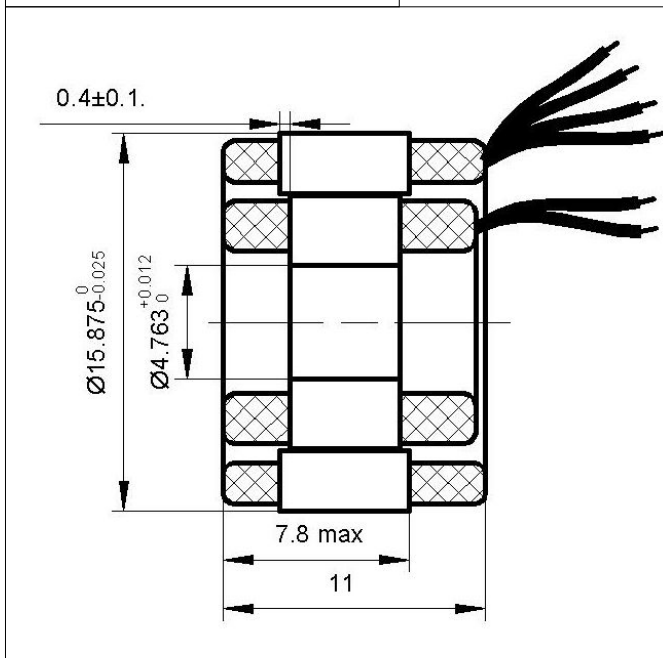

SCHEMATIC DIAGRAM:

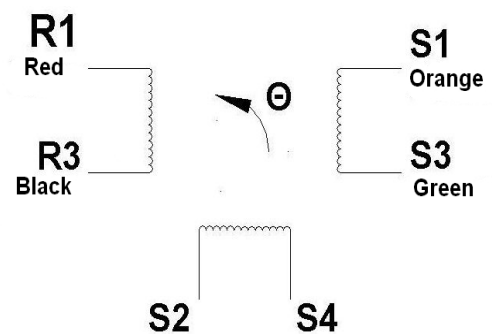

$$E_{S1-S3} = K E_{R1-R3} \cos \Theta$$

$$E_{S2-S4} = K E_{R1-R3} \sin \Theta$$

Θ positive for CCW rotation
(wire lead front)

The product is manufactured to meet the requirements of
SR EN ISO 9001/2008 ; 14001/2005 ; SR OHSAS 18001/2008