

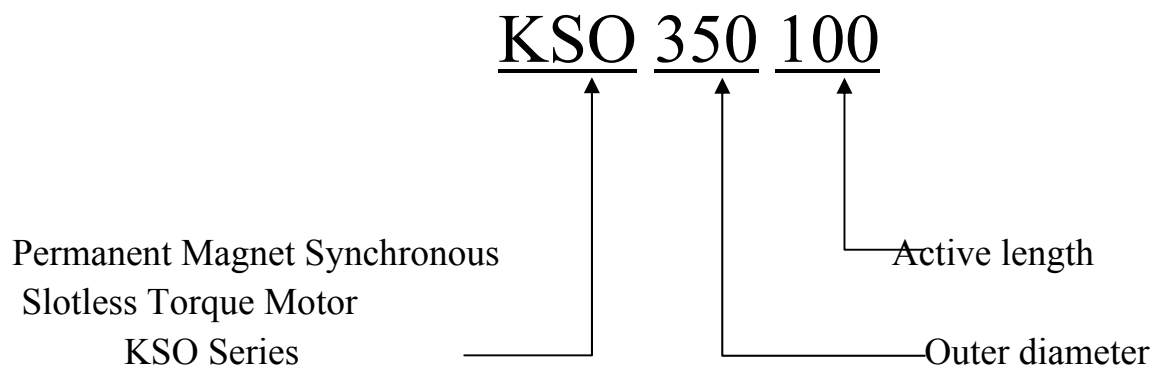

Permanent Magnet Synchronous Frameless Slotless Motor



Icepe

313 Splaiul Unirii

030138, București, România

tel./ fax +40213467233

email servo@icpe.ro

web <http://www.icpe.ro/>



Product Description

The frameless, slotless motor of KSO 350 100 is a high performance brushless synchronous motor excited by rare earth permanent magnets located on the rotor. This motor is delivered as frameless kit (rotor and stator sets) and was optimized for increased torque density, zero cogging torque, compact design at minimal cost.

The stator core consists of a ring made of laminated steel. Due to the slotless configuration, the three phase star connected winding is placed in the airgap between stator core and permanent magnets. The winding is encapsulated in epoxy resin. The rotor consists of a magnetic steel ring on which there are placed high energy permanent magnets. This motor was designed to offer very low torque ripple combined with zero cogging torque.

This slotless, frameless kit motor can be used as direct drive motor providing the advantages of lower cost, increased reliability and improved performance. This motor can be customized in order to be easily adapted to a wide range of applications. The winding can be customized for different bus voltage values.

Features

- Zero cogging torque
- Designed to be compact, high performance and cost effective
- Very low torque ripple
- Smooth operation
- Allow direct coupling with the payload, eliminating parts of mechanical transmission
- Maintenance free
- High energy NdFeB magnets maximize torque density
- Customized winding for different desired voltage

Applications

- Machine tools
- Laser scanning and printing
- Motion simulators
- Rotary stage
- Robots



Torque motor KSO 350 100 Specifications

Parameters	Tolerances	Units	KSO 350 100
External diameter	h7	<i>mm</i>	350
Inner diameter	H7	<i>mm</i>	240
Total length	Max	<i>mm</i>	135
Continuous stall torque	±10%	<i>Nm</i>	100
Peak torque	±10%	<i>Nm</i>	400
Rated voltage*	±10%	<i>V_{DC}</i>	325
Continuous stall current**	±10%	<i>A_{rms}</i>	10
Peak current	±10%	<i>A_{rms}</i>	43
Rated speed	±10%	<i>rpm</i>	10
No load speed	±10%	<i>rpm</i>	400
Torque constant (K _T)	±10%	<i>Nm/A_{RMS}</i>	10
Back EMF constant (K _E)	±10%	<i>V_{peak}/Krpm</i>	876
Thermal resistance	±10%	<i>°C/W</i>	0.17
Total friction torque	±10%	<i>mNm peak</i>	0
Inertia	±10%	<i>Kg·m²</i>	0.38
Weight	±10%	<i>Kg</i>	32
Phase connection			Y
Number of poles			40
Electrical resistance (at 20°C)	±10%	<i>Ω</i>	3.3
Electrical inductance	±20%	<i>mH</i>	3.2

*, ** More voltage and current values available on request



Torque motor KSO 350 100 Dimensions

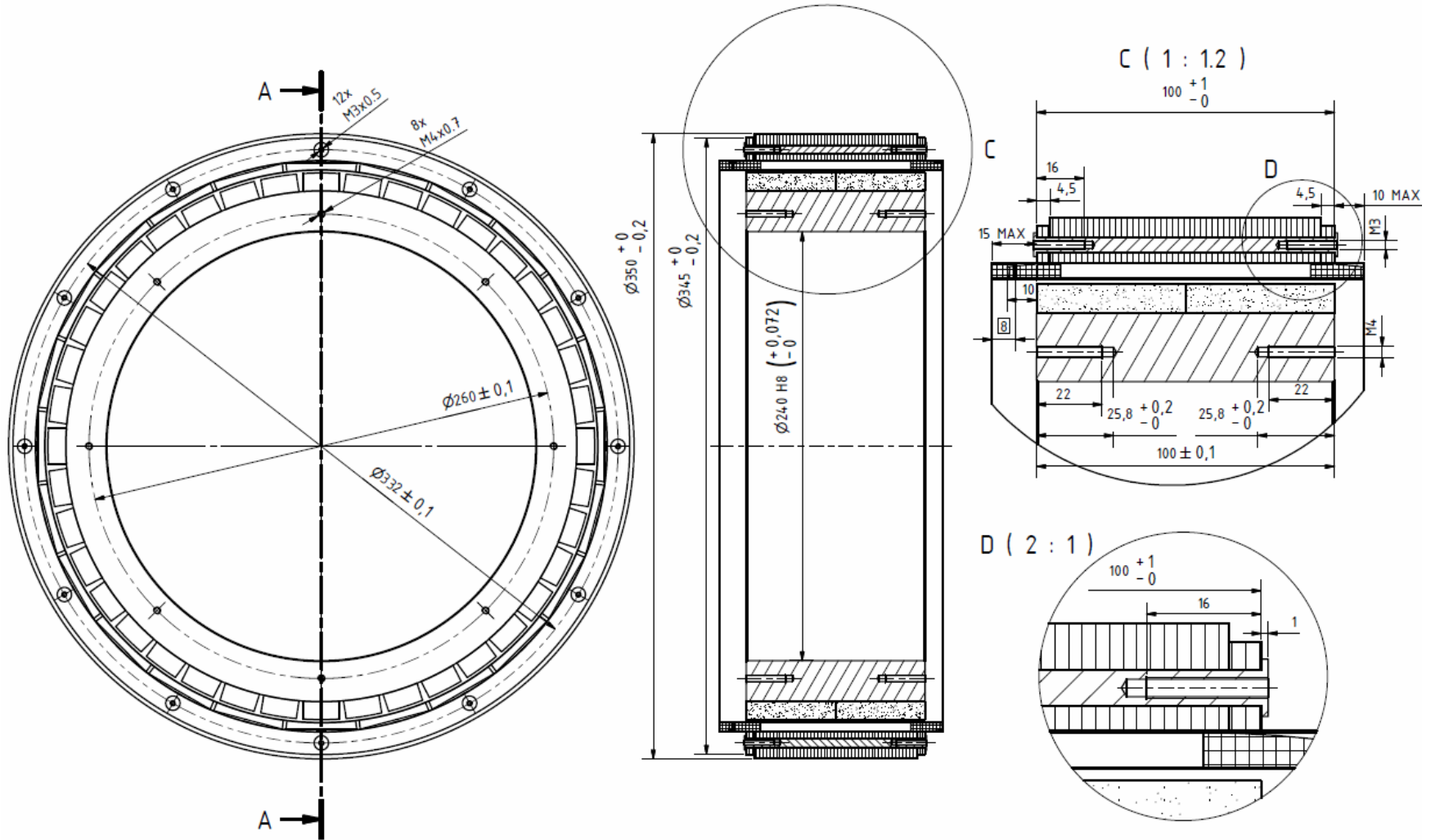

* Dimension in mm

** Different stack length available on request



Torque motor KSO 000 000 Performances

